

PEKAN SERDANG
SKALA 1 : 400

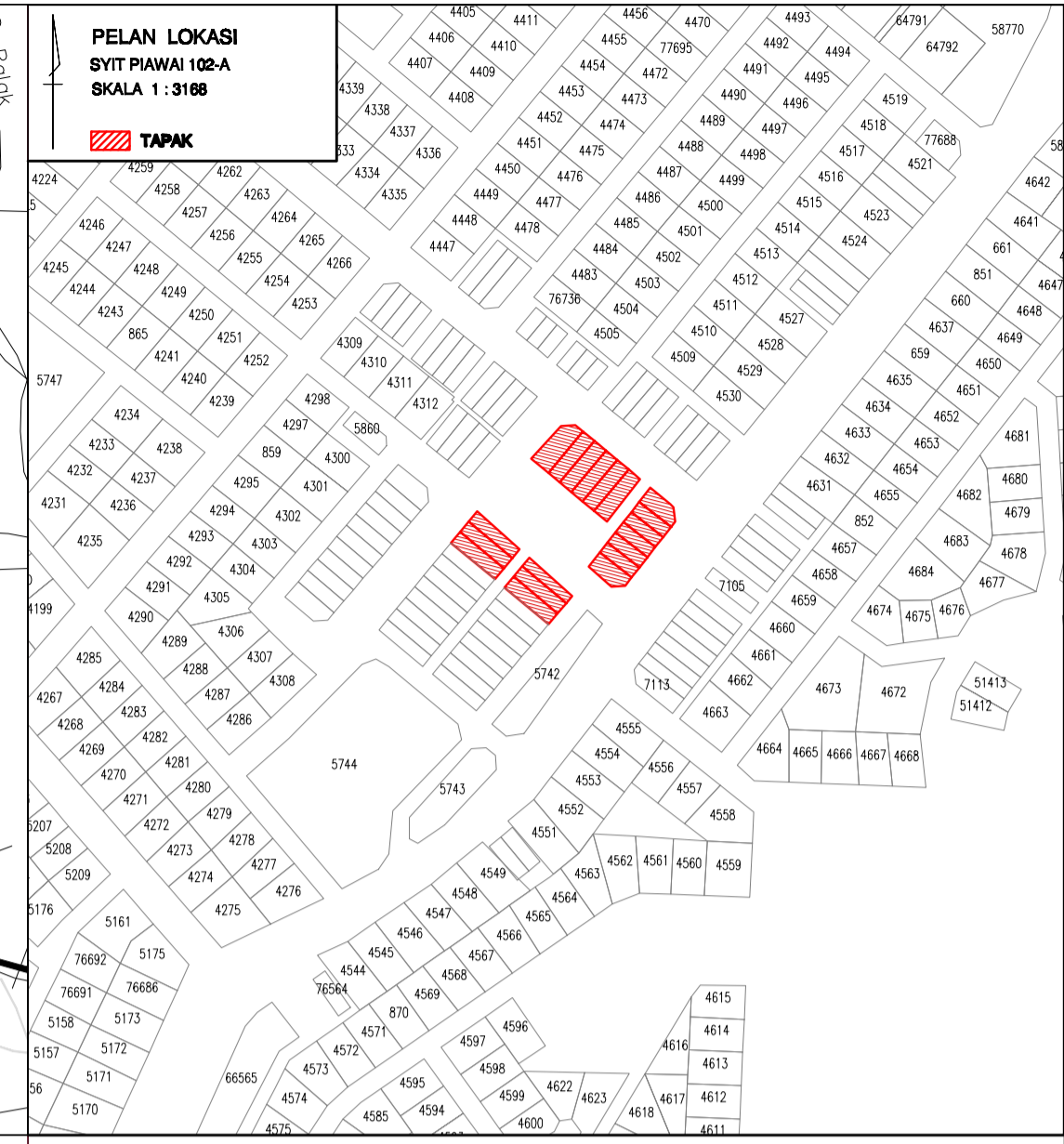
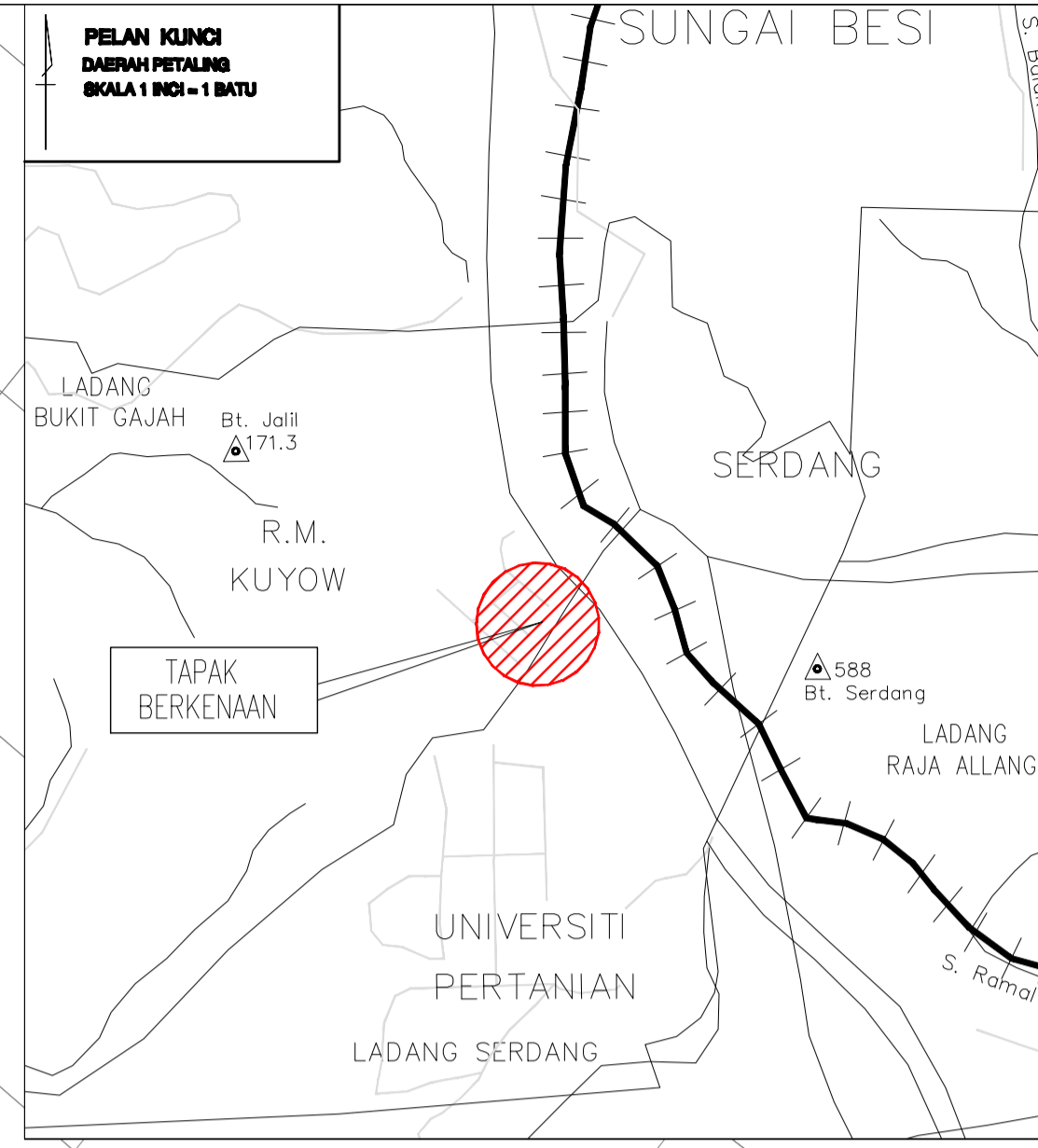
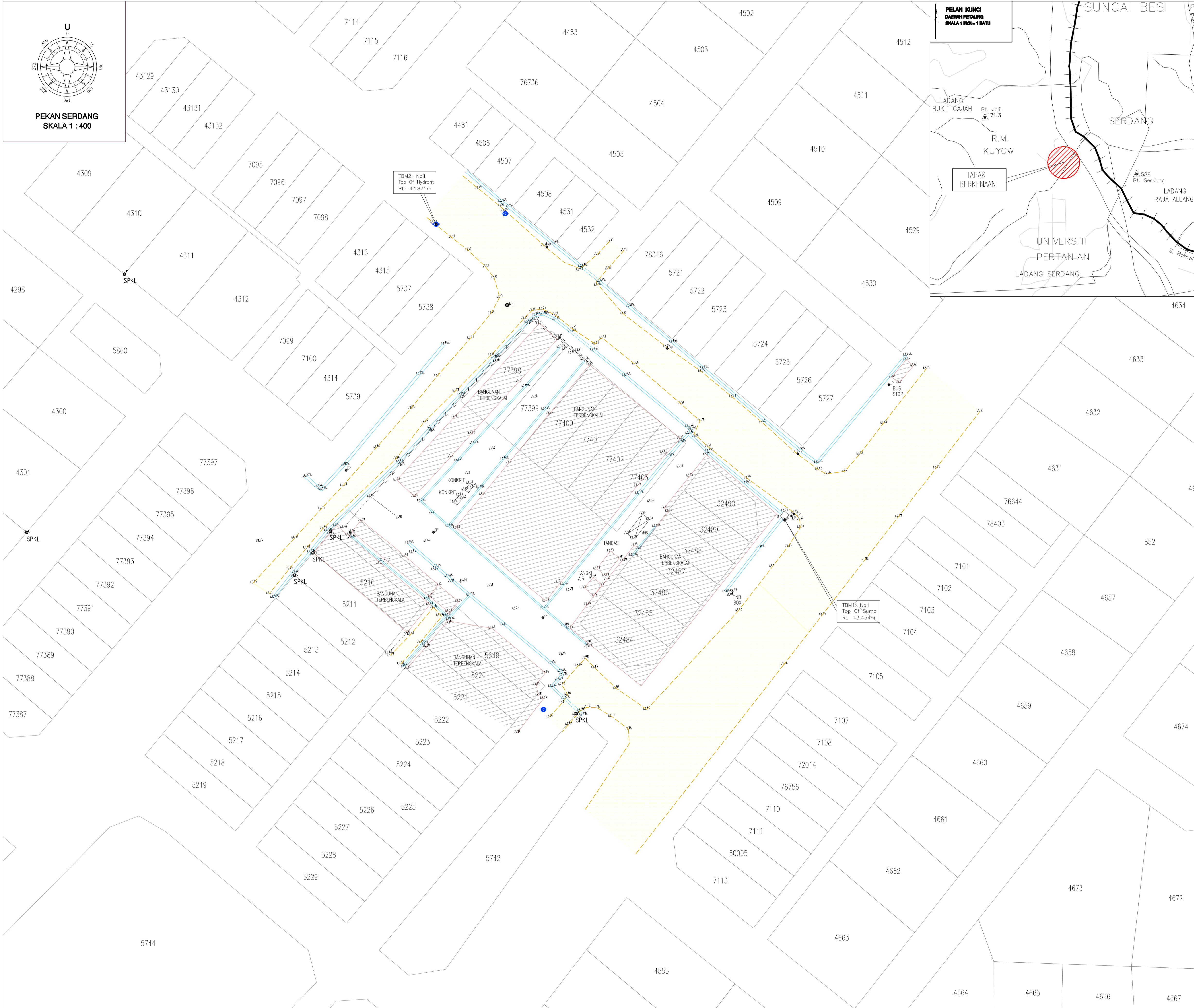

TAJUK PROJEK:
**UKURAN BUTIRAN DAN TITIK ARAS
DI PEKAN SERDANG
DAERAH PETALING
SELANGOR DARUL EHSAN**

TAJUK PELAN:
PELAN TOPOGRAFI

PEMILIK:

PANDUAN:

| | |
|----------------------|--------------------------|
| Jalan Tar | Pili Bomba |
| Bangunan | EP Tiang Elektrik |
| Longkang Konkrit | LP Tiang Lampu |
| Pagor Dawai | Sump |
| Pagor Zink | IL Invert Level |
| MHS Manhole (SEPTIK) | SPKL Spike Lama |
| MH Manhole | TBM Temporary Bench Mark |

NOTA:
1.) SEMUA UKURAN ADALAH DALAM METER
2.) SEMUA ARAS LARAS ADALAH BERDASARKAN BM B.5338 (AL : 42.883m)

JURUKUR BERLESEN :



MUHD IBRAHIM B. MUHAMMAD ISAHAK
B.Survey (UNSW Sydney, AUSTR.) MSM, MAALS
Jurukur Tanah Yang Diiktiraf Di Bawah
Akta 458 (Disemak 1991)



IBR UKUR CONSULTANT
Licensed Land Surveyor
Consultant in Land and Housing Development,
Survey Services in Land and Strata Titles, Engineering,
Topographical, Hydrographic and Mining Surveying.
Suites A-2-9, Tingkat 2,
Setiawangsa Business Suites
No.1, Jalan Setiawangsa 11
Taman Setiawangsa
54200 Hulu Kelang

| | |
|--|------------------------------|
| DIUKUR OLEH: DIN | DISEMAK OLEH: SAFUDIN |
| DILUKIS OLEH: -HAMIZI- | TARIKH: NOVEBER 2024 |
| NO. PELAN : SE/001/SK/SEL/TP-01 | |